



AP01
Alarm panel

MANUAL

AP01

CONTENTS

Description.....	2
General system overview	3
Connection.....	4
Specification.....	5

DESCRIPTION

The AP01 is an alarm panel for public locations, designed to display possible fault alarms, for example damper faults and detector faults. The AP01 is connected to the SUSAs master unit. In this system, up to 516 dampers can be monitored in 256 groups and 130 detector groups. The AP01 has a built-in audible alarm and LED indication which are activated automatically from the SUSAs when a fault alarm is triggered. After the fault is corrected in the system, the service personnel manually resets the fault alarm in the SUSAs, which then removes the fault alarm in the AP01.

The AP01 is only compatible with the software version FW 3.0 or later in the SUSAs unit.

- Audible alarm 50dB(A) with a button to mute the alarm.
- 1 red alarm LED (A & B alarm).
- 1 green operation LED (power on).

GENERAL SYSTEM OVERVIEW

A typical example is illustrated below with three AP01 units connected in series to the SUSa unit. The AP01 displays alarms for faults that occur locally in the SUSa and all slave units via IS-BUS.

You can also visit our website oncontrol.se to use our product selection program.

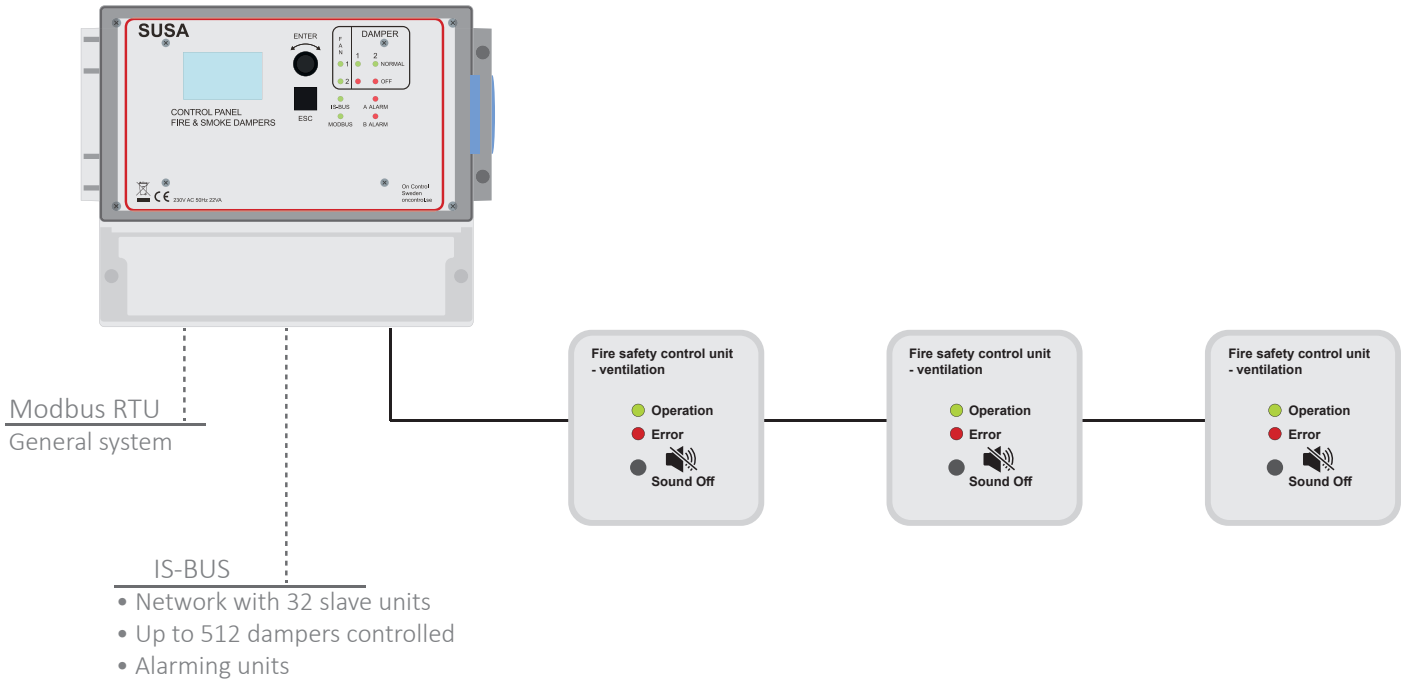

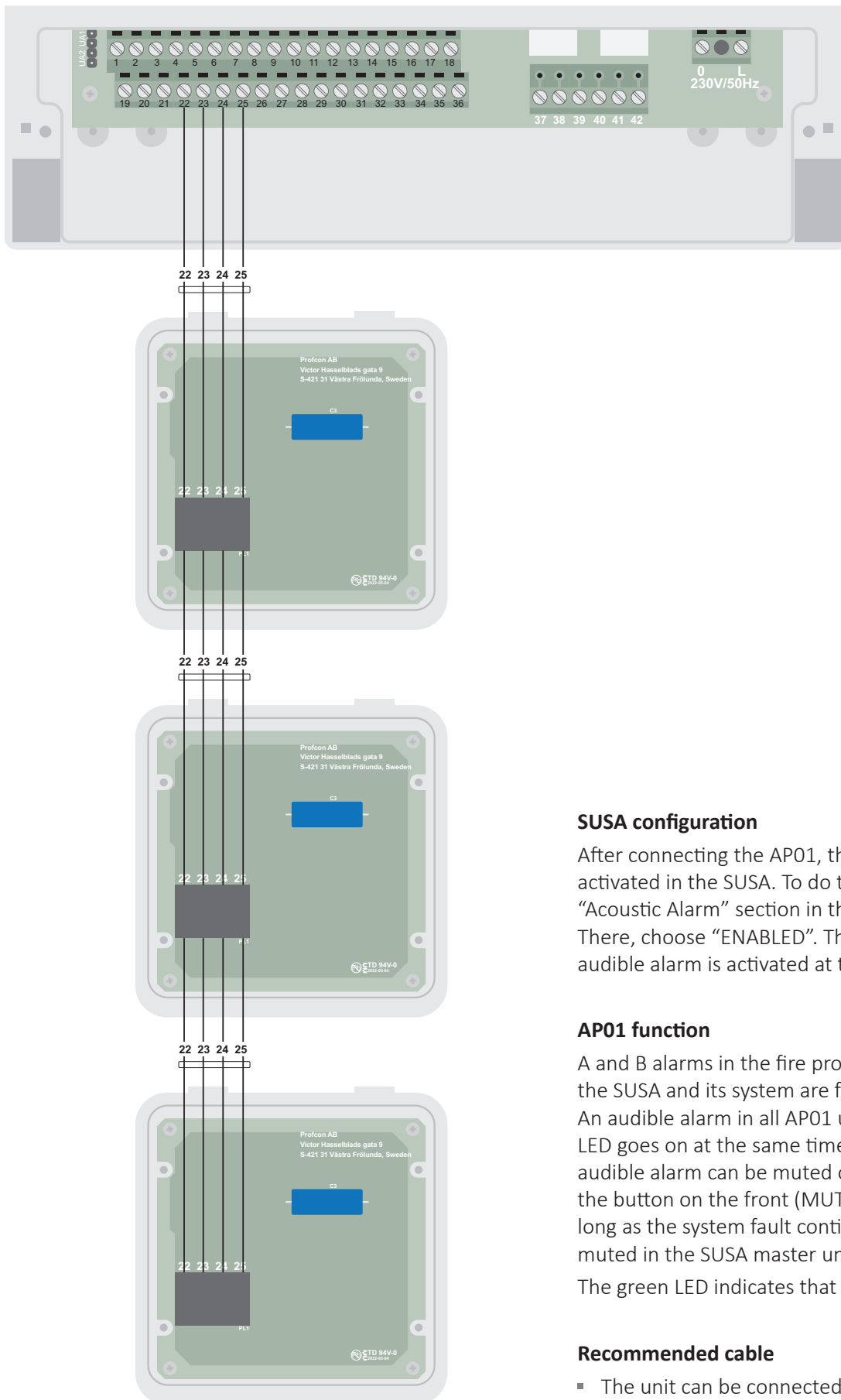

SUSA configuration

After connecting the AP01, the output must be activated in the SUSA. To do this, navigate to the “Acoustic Alarm” section in the SUSA display menu. There, choose “ENABLED”. The SUSA unit’s own internal audible alarm is activated at the same time.

AP01 function

A and B alarms in the fire protection area belonging to the SUSA and its system are forwarded to the AP01. An audible alarm in all AP01 units sounds and the red LED goes on at the same time to indicate the fault. The audible alarm can be muted on the AP01 by pressing the button on the front (MUTE). The RED stays on as long as the system fault continues or until the alarm is muted in the SUSA master unit.

The green LED indicates that the AP01 has power.

Recommended cable

- The unit can be connected using EKKX 1×4×0.5 for example, with a total length of up to 100 metres.

SPECIFICATION

Compatibility

SUSA with FW 3.0 or later

Maximum configuration

Up to three units can be connected in series to the SUSA master unit.

Installation

Screwed to the wall. Predefined hole pattern for installation on an EU box. To open the front, twist gently with screwdrivers in the two openings in the bottom side of the box.

Power supply

Power is supplied from the SUSA unit as shown on page 4.

Ambient temperature

Max +35 °C, min -5 °C

Weight

85 g

Dimensions

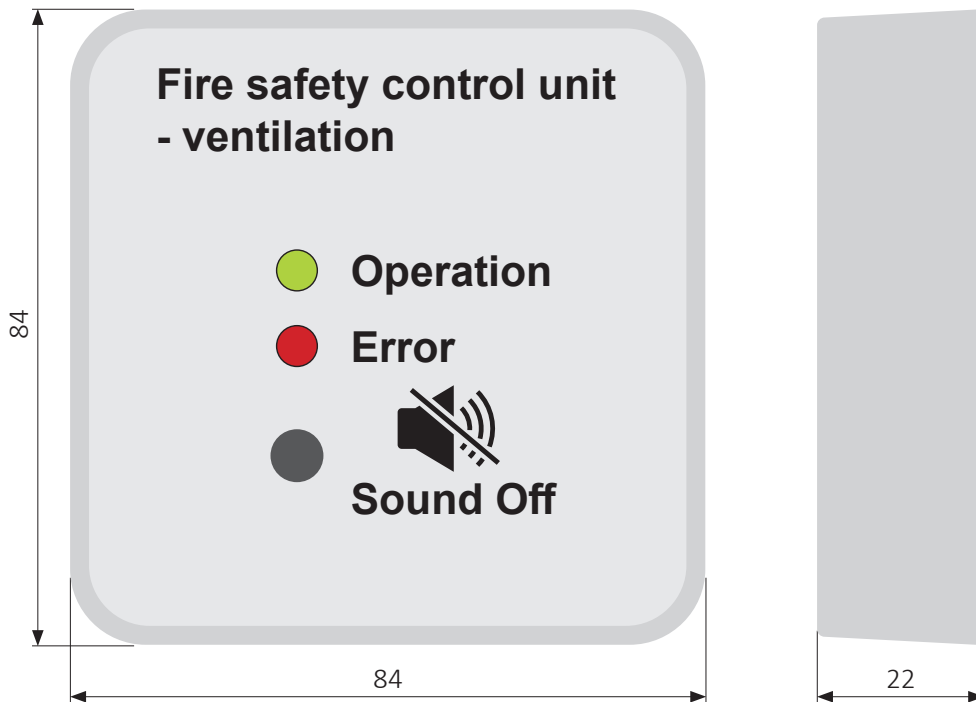

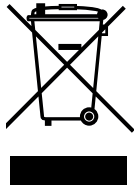

**Disposal of used electrical and electronic equipment
(applies to the EU and other European countries with a dedicated collection system)**

If this symbol appears on the product or its packaging, the product must not be treated as household waste. Instead, it must be sent to a suitable collection point that recycles electrical and electronic equipment. By making sure this product is correctly processed, you will help to prevent the negative impact on the environment and on human health that could result from inappropriate waste handling. Recycling helps to conserve natural resources. To find out more about recycling this product you can contact your local authority, your cleaning contractor or the dealer you purchased the product from.

PROFCON AB

Victor Hasselblads gata 9
421 31 Västra Frölunda
Sweden

Tel: +46 (0)33 25 65 70

Web: oncontrol.se

On Control is a registered trade mark of PROFCON AB